

iPad Trouble Shooting

Logging into the eCHAM you see a login error:

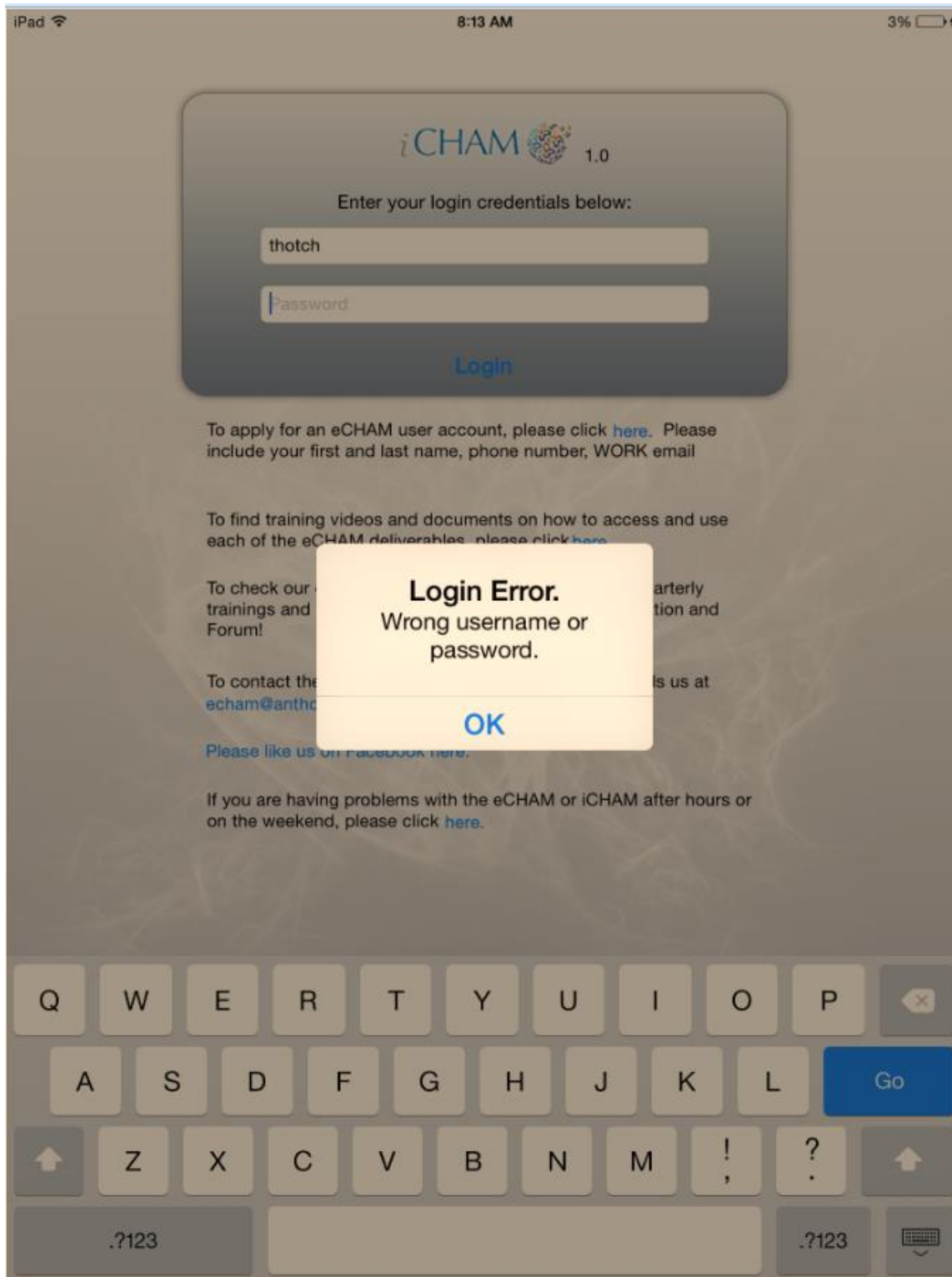

Go to Settings on your Home Screen, the placement of the icon may be different but looks the same.

iPad Trouble Shooting



iPad Trouble Shooting

Check the Wifi Setting: Is it on, is it connected?

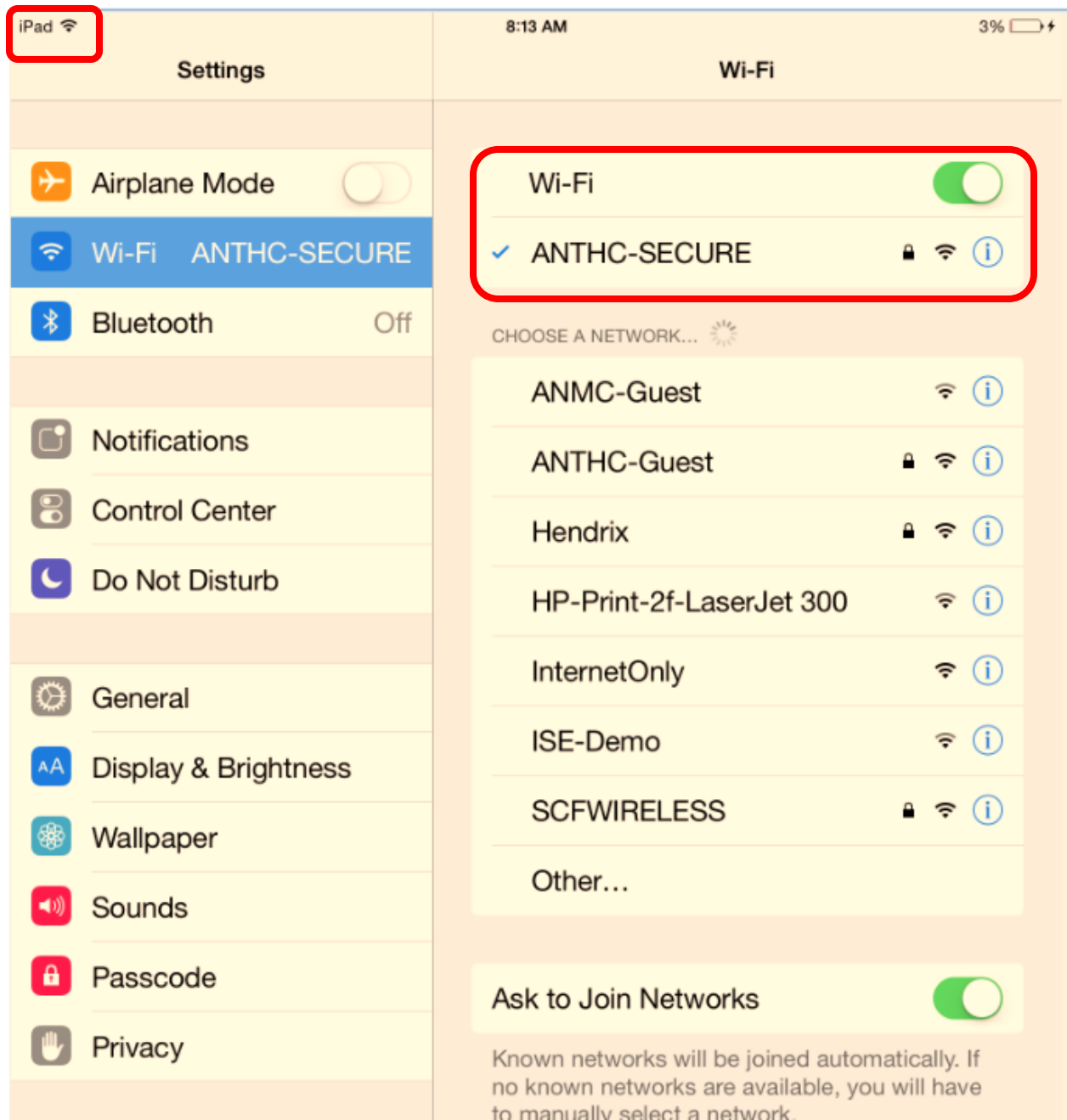

If yes. Try logging into your iCHAM again.

iPad Trouble Shooting

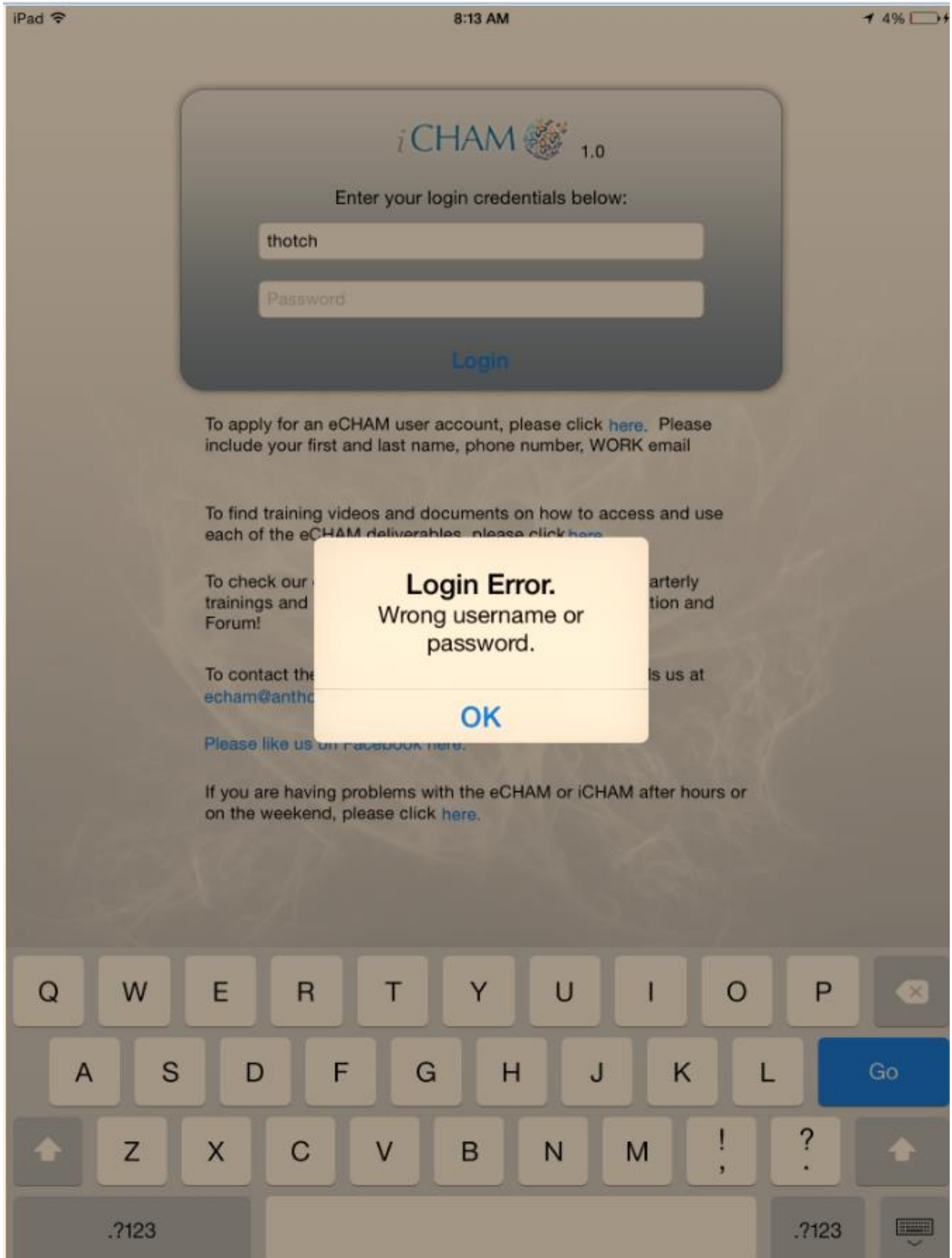

iPad Trouble Shooting

If that didn't work; go to Settings again. Check for software updates.

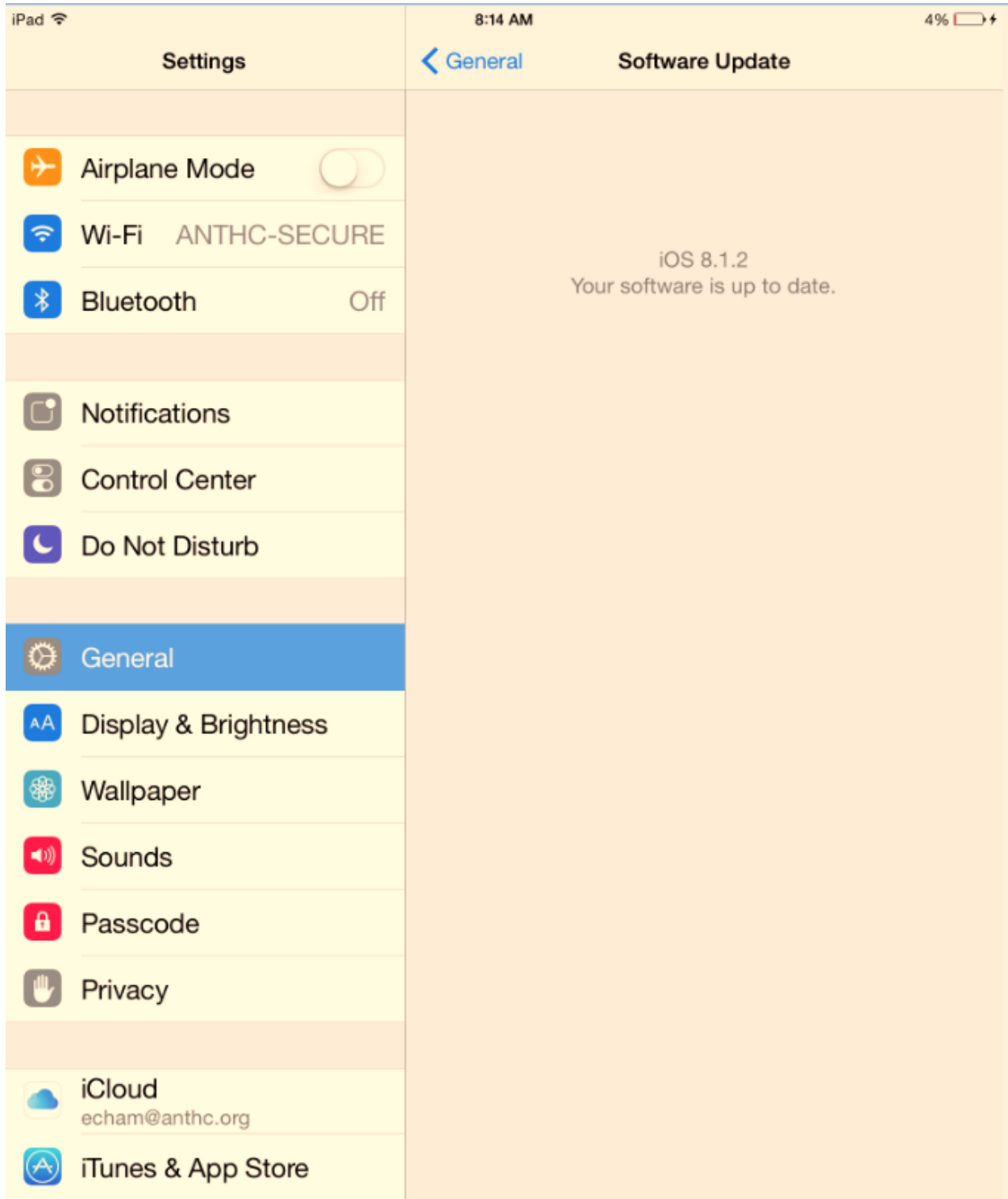

If your software is up to date, try turning your iPad off, by pushing the top button until the slide bar appears to turn off. Slide to turn off, wait 30 seconds then power back on.